



# SWEETWATER

## COUNTY

### Key to FY 2026 STIP

- 2026
- FUTURE
-  AERONAUTICS
-  TRANSIT
-  URBAN BOUNDARY

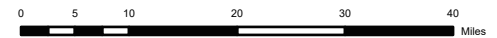
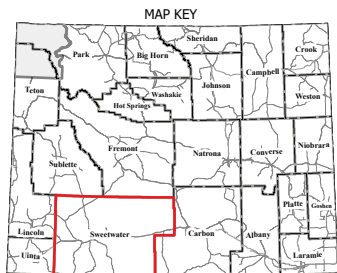
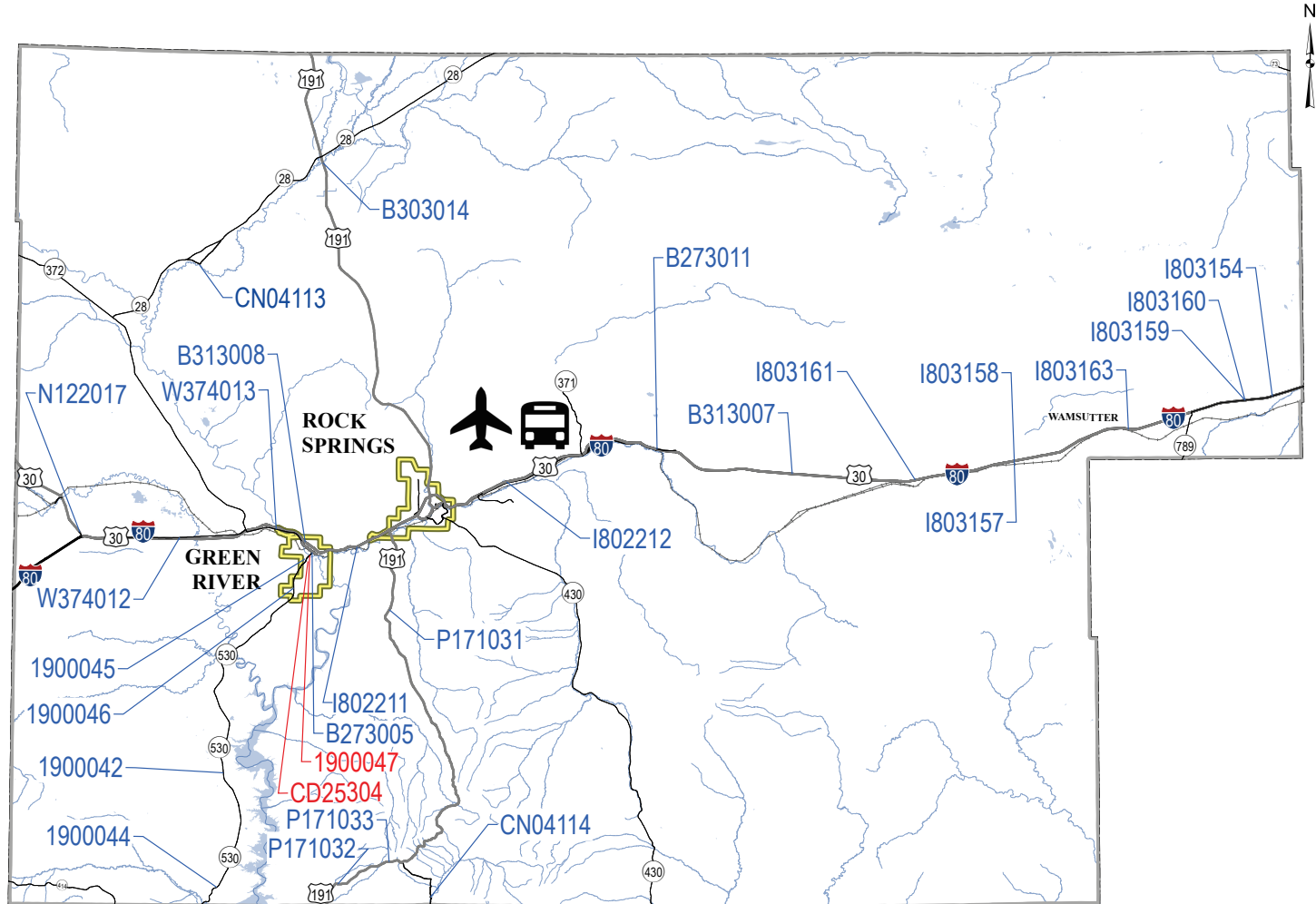

# GREEN RIVER

## INSET

SWEETWATER COUNTY

### Key to FY 2026 STIP

- 2026
- FUTURE
-  AERONAUTICS
-  TRANSIT
-  URBAN BOUNDARY

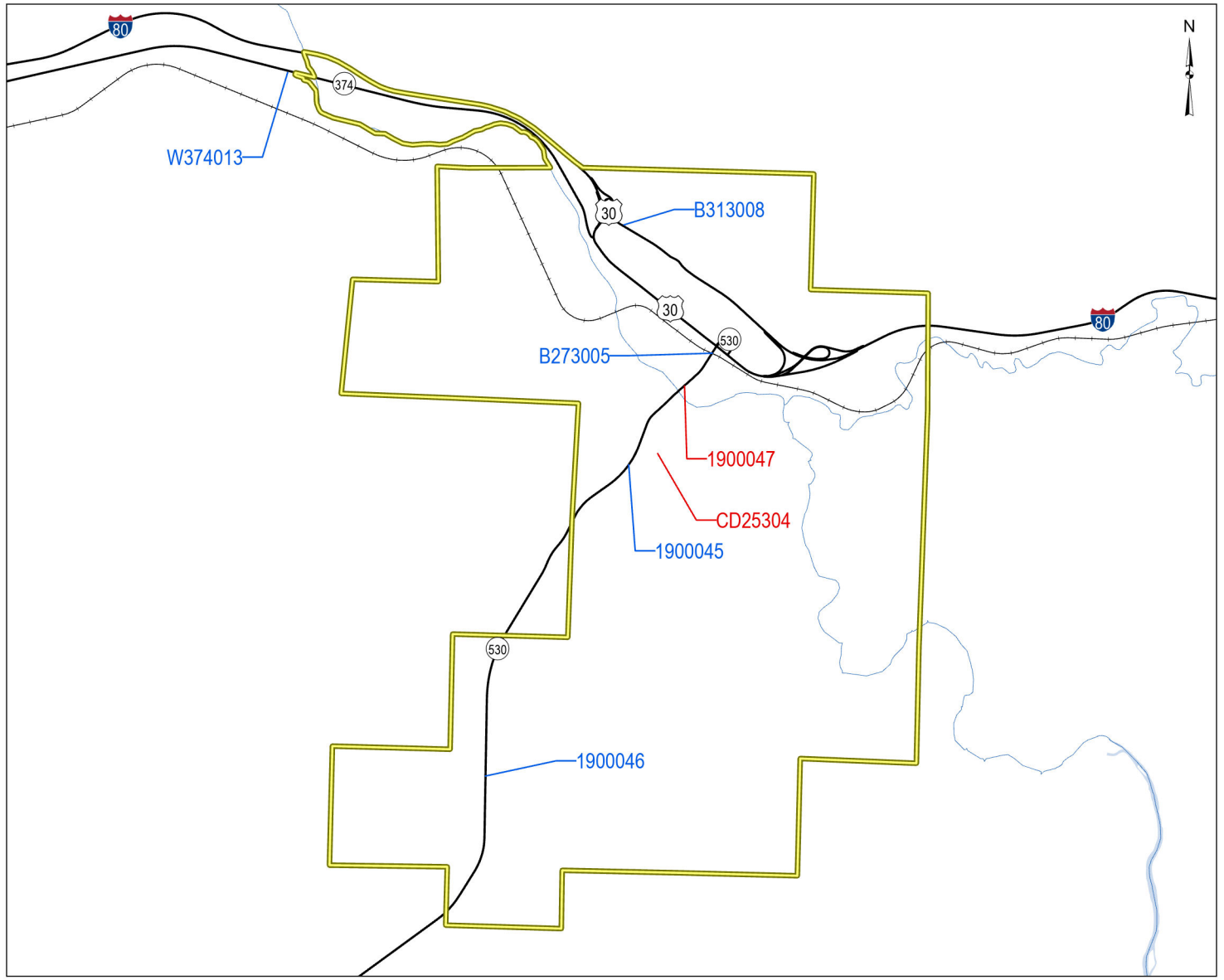
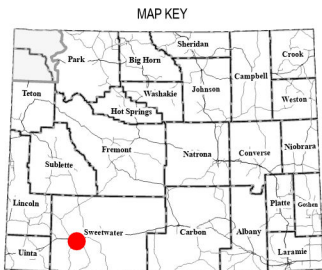

# ROCK SPRINGS

## INSET

SWEETWATER COUNTY

### Key to FY 2026 STIP

- 2026
- FUTURE
-  AERONAUTICS
-  TRANSIT
-  URBAN BOUNDARY

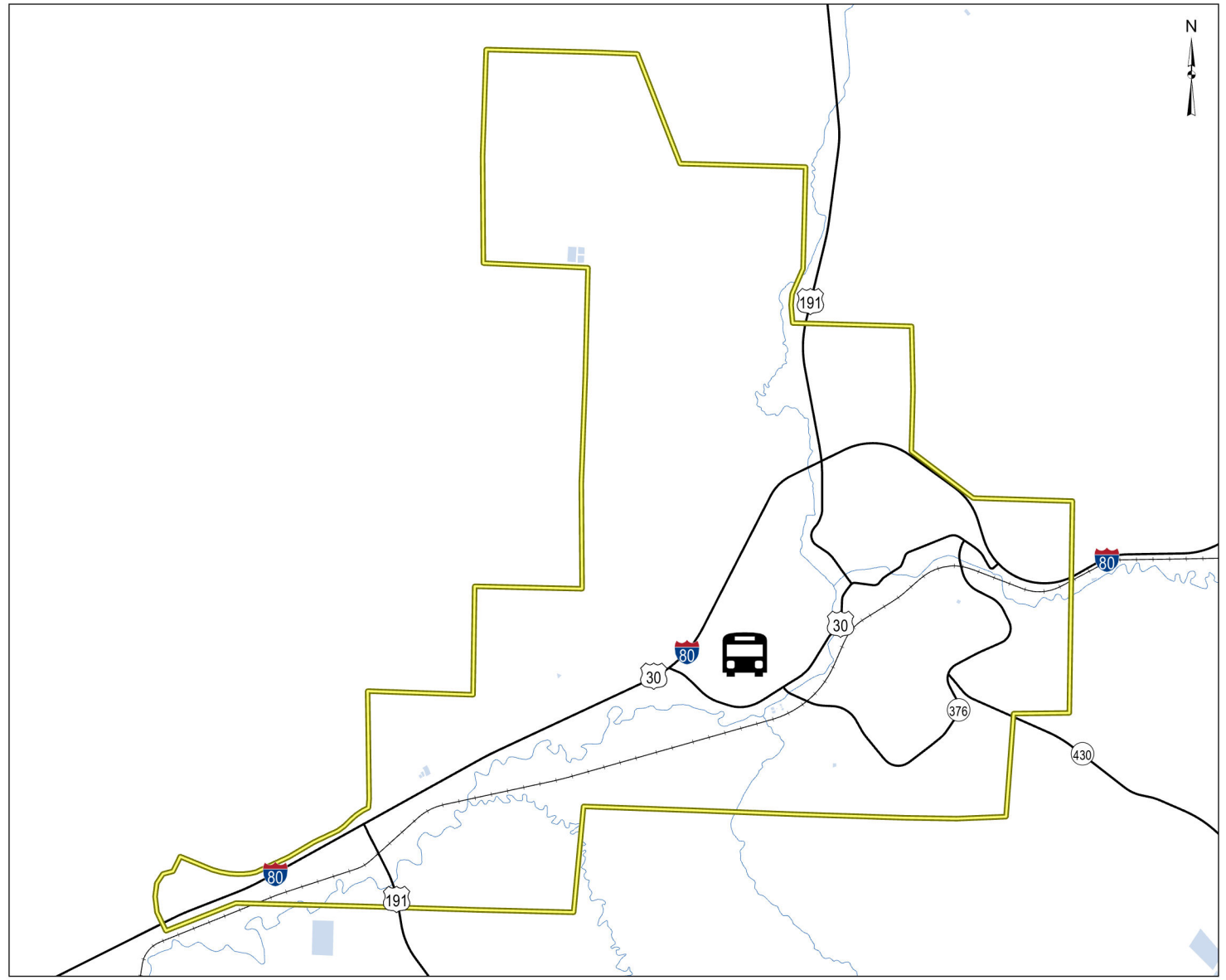



Wyoming Department of Transportation  
 5300 Bishop Blvd  
 Cheyenne, WY 82009

## STATE TRANSPORTATION IMPROVEMENT PROJECTS ENGINEERING & CONSTRUCTION

WYCN002B

### Sweetwater County

#### Transportation Projects

Fiscal Year: 2026

Trans Comm Dist	Project		General Location Detail Location	Begin RM	End RM	Length	Character of Work	Cost \$1,000						
								PE FY	PE	CE & CON	TOTAL	FED	ST	OTH
2	HSIP	1900047	GREEN RIVER WY 530 STRUCTURE NO. CVL, DNJ	0.45	0.60	0.15	SAFETY IMPROVEMENTS TO INCLUDE REPLACEMENT OF CONDUIT AND LUMINAIRES		33	250	283	247	36	0
2	PRT	B243039	TRANSPORTATION DISTRICT 3 AREAS ALONG I-80 AND WY 374	0.00	0.00	0.00	SAFETY IMPROVEMENTS TO INCLUDE ROCK FALL MONITORING		250	0	250	200	50	0
2	STP-PM	B263026	TRANSPORTATION DISTRICT 3 VARIOUS LOCATIONS	100.00	128.22	28.22	PAVEMENT MAINTENANCE TO INCLUDE CHIP SEAL	2025	104	2,000	2,104	1,904	200	0
2	STP-PM	B263031	TRANSPORTATION DISTRICT 3 VARIOUS LOCATIONS	104.07	106.48	2.41	PAVEMENT MAINTENANCE TO INCLUDE CONCRETE SLAB REPLACEMENT	2025	36	500	536	485	51	0
2	CD	CD25304	GREEN RIVER MONROE AVENUE IN FRONT OF MONROE ELEMENTARY AND LINCOLN MIDDLE SCHOOL LPA-CITY OF GREEN RIVER	100.00	100.46	0.46	COMMUNITY DEVELOPMENT TO INCLUDE ADA UPGRADES		0	344	344	312	0	33
<b>FY TOTAL:</b>						<b>31.24</b>		<b>\$423</b>	<b>\$3,094</b>	<b>\$3,517</b>	<b>\$3,148</b>	<b>\$337</b>	<b>\$33</b>	



Wyoming Department of Transportation  
5300 Bishop Blvd  
Cheyenne, WY 82009

## STATE TRANSPORTATION IMPROVEMENT PROJECTS ENGINEERING & CONSTRUCTION

WYCN002B

### Sweetwater County

#### Transit Projects

Fiscal Year: 2026

Trans Comm Dist	Project		General Location Eligible Provider	Funding Source	Character of Work	Cost \$1,000						
						PE FY	PE	CE & CON	TOTAL	FED	ST	OTH
2	FTA	FT26332	ROCK SPRINGS SWEETWATER COUNTY TRANSIT AUTHORITY RESOURCES	5311	OPERATING/ADMIN/MAINT		0	695	695	461	0	235
2	FTA	FT26373	ROCK SPRINGS SWEETWATER COUNTY TRANSIT AUTHORITY RESOURCES	5339	PURCHASE ONE LIGHT-DUTY VAN		0	170	170	29	0	141
<b>FY TOTAL:</b>							<b>\$0</b>	<b>\$865</b>	<b>\$865</b>	<b>\$490</b>	<b>\$0</b>	<b>\$376</b>

#### Aeronautics Projects

Fiscal Year: 2026

Aero Comm Dist	Project		General Location	Character of Work	Cost \$1,000							
					PE FY	PE	CE & CON	TOTAL	FED	ST	OTH	
2	AERO	ARK031A	ROCK SPRINGS	AIRPORT EQUIPMENT		0	450	450	0	338	113	
2	AERO	ARK034B	ROCK SPRINGS	PAVEMENT REHABILITATION		0	1,579	1,579	39	39	1,500	
2	AERO	ARK040B	ROCK SPRINGS	BUILDINGS		0	4,211	4,211	4,000	105	105	
2	AERO	ARK042A	ROCK SPRINGS	AIRPORT EQUIPMENT		0	600	600	0	150	450	
<b>FY TOTAL:</b>							<b>\$0</b>	<b>\$6,840</b>	<b>\$6,840</b>	<b>\$4,039</b>	<b>\$632</b>	<b>\$2,168</b>
<b>Grand Total: 2026, Sweetwater County</b>							<b>\$423</b>	<b>\$10,799</b>	<b>\$11,222</b>	<b>\$7,677</b>	<b>\$969</b>	<b>\$2,577</b>



Wyoming Department of Transportation  
 5300 Bishop Blvd  
 Cheyenne, WY 82009

## STATE TRANSPORTATION IMPROVEMENT PROJECTS ENGINEERING & CONSTRUCTION

WYCN002B

### Sweetwater County

#### Transportation Projects

Fiscal Year: 2027

Trans Comm Dist	Project		General Location Detail Location	Begin RM	End RM	Length	Character of Work	Cost \$1,000						
								PE FY	PE	CE & CON	TOTAL	FED	ST	OTH
2	STP-BR	B273005	TRANSPORTATION DISTRICT 3 STRUCTURE NO. DDH	0.32	0.32	0.00	STRUCTURE REPAIR	2024	79	1,250	1,329	1,193	135	0
2	HI-BFP	B273011	TRANSPORTATION DISTRICT 3 STRUCTURE NO. AQY, AQZ	130.84	130.84	0.00	BRIDGE REPLACEMENT	2023	219	4,481	4,700	4,253	447	0
2	SSP-TO	B273013	SWEETWATER COUNTY I-80 ON LABARGE EASTBOUND ON- RAMP/LABARGE EASTBOUND MAINLINE/COVERED WAGON EASTBOUND ON-RAMP/WY430 SOUTHBOUND AT WY 370 INTERSECTION	83.00	83.00	0.00	TRAFFIC SYSTEMS TO INCLUDE ROAD CLOSURE SYSTEMS		65	605	670	0	670	0
2	SCP-TC	B273028	TRANSPORTATION DISTRICT 3 VARIOUS LOCATIONS	88.80	106.48	17.68	PAVEMENT MAINTENANCE TO INCLUDE CONCRETE SLAB REPLACEMENT	2026	39	750	789	35	754	0
2	HSIP	I802212	ROCK SPRINGS TO RAWLINS I-80 EASTBOUND/WESTBOUND LANES	107.60	120.30	12.70	SAFETY IMPROVEMENTS TO INCLUDE CENTER AND EDGE LINE MARKINGS	2026	57	1,100	1,157	1,157	0	0
2	NHPP1	I803157	ROCK SPRINGS TO RAWLINS I-80 WESTBOUND LANE STRUCTURE NO. ARZ, ASE, LZS, LZU, LZW	161.99	174.40	12.41	PAVEMENT REHABILITATION TO INCLUDE MILL, OVERLAY AND WEARING COURSE	2024	1,104	31,477	32,582	30,213	2,368	0



Wyoming Department of Transportation  
 5300 Bishop Blvd  
 Cheyenne, WY 82009

## STATE TRANSPORTATION IMPROVEMENT PROJECTS ENGINEERING & CONSTRUCTION

WYCN002B

### Sweetwater County

#### Transportation Projects

Fiscal Year: 2027

Trans Comm Dist	Project		General Location Detail Location	Begin RM	End RM	Length	Character of Work	Cost \$1,000						
								PE FY	PE	CE & CON	TOTAL	FED	ST	OTH
2	NHPPI	I803158	ROCK SPRINGS TO RAWLINS I-80 EASTBOUND LANE STRUCTURE NO. ARY, ASD, LZR, LZT, LZV	161.99	174.40	12.41	PAVEMENT REHABILITATION TO INCLUDE MILL, OVERLAY AND WEARING COURSE		1,094	0	1,094	1,015	79	0
2	HSIP	N122017	KEMMERER TO GRANGER US 30	99.65	99.65	0.00	SAFETY IMPROVEMENTS TO INCLUDE AN OVERHEAD SIGN	2024	39	433	471	472	0	0
<b>FY TOTAL:</b>						<b>55.20</b>		<b>\$2,696</b>	<b>\$40,096</b>	<b>\$42,792</b>	<b>\$38,338</b>	<b>\$4,453</b>	<b>\$0</b>	

#### Aeronautics Projects

Fiscal Year: 2027

Aero Comm Dist	Project		General Location	Character of Work	Cost \$1,000								
					PE FY	PE	CE & CON	TOTAL	FED	ST	OTH		
2	AERO	ARK024A	ROCK SPRINGS	PAVEMENT EXPANSION		0	3,200	3,200	3,000	120	80		
<b>FY TOTAL:</b>						<b>\$0</b>	<b>\$3,200</b>	<b>\$3,200</b>	<b>\$3,000</b>	<b>\$120</b>	<b>\$80</b>		
<b>Grand Total: 2027, Sweetwater County</b>								<b>\$2,696</b>	<b>\$43,296</b>	<b>\$45,992</b>	<b>\$41,338</b>	<b>\$4,573</b>	<b>\$80</b>



Wyoming Department of Transportation  
 5300 Bishop Blvd  
 Cheyenne, WY 82009

## STATE TRANSPORTATION IMPROVEMENT PROJECTS ENGINEERING & CONSTRUCTION

WYCN002B

### Sweetwater County

#### Transportation Projects

Fiscal Year: 2028

Trans Comm Dist	Project		General Location Detail Location	Begin RM	End RM	Length	Character of Work	Cost \$1,000						
								PE FY	PE	CE & CON	TOTAL	FED	ST	OTH
2	STP	1900046	GREEN RIVER TO UTAH GREEN RIVER SOUTH/WY 530	2.40	7.23	4.83	PAVEMENT REHABILITATION TO INCLUDE MILL, LEVEL, OVERLAY AND WEARING COURSE	2022	373	3,948	4,321	3,910	411	0
2	HI-BFP	CN04113	SWEETWATER COUNTY COUNTY ROAD 5/BLUE RIM ROAD OVER BIG SANDY RIVER STRUCTURE NO. ETE	36.55	36.55	0.00	BRIDGE REPLACEMENT		217	2,660	2,877	2,877	0	0
2	HI-BFP	CN04114	SWEETWATER COUNTY COUNTY ROAD 62 SPANNING RED CREEK STRUCTURE NO. ENX	5.55	5.55	0.00	BRIDGE REPLACEMENT		213	2,675	2,888	2,888	0	0
<b>FY TOTAL:</b>						<b>4.83</b>			<b>\$803</b>	<b>\$9,283</b>	<b>\$10,086</b>	<b>\$9,675</b>	<b>\$411</b>	<b>\$0</b>
<b>Grand Total: 2028, Sweetwater County</b>									<b>\$803</b>	<b>\$9,283</b>	<b>\$10,086</b>	<b>\$9,675</b>	<b>\$411</b>	<b>\$0</b>



Wyoming Department of Transportation  
5300 Bishop Blvd  
Cheyenne, WY 82009

## STATE TRANSPORTATION IMPROVEMENT PROJECTS ENGINEERING & CONSTRUCTION

WYCN002B

### Sweetwater County

#### Transportation Projects

Fiscal Year: 2029

Trans Comm Dist	Project		General Location Detail Location	Begin RM	End RM	Length	Character of Work	Cost \$1,000						
								PE FY	PE	CE & CON	TOTAL	FED	ST	OTH
2	STP	1900044	GREEN RIVER UTAH LINE NORTH/WY 530	38.74	44.81	6.07	PAVEMENT REHABILITATION TO INCLUDE MILL, LEVEL, OVERLAY AND CHIP SEAL	2021	121	5,646	5,767	5,219	548	0
2	NHPP1	1802211	ROCK SPRINGS TO GREEN RIVER I-80	92.00	99.00	7.00	PAVEMENT RESURFACE TO INCLUDE HIGH PERFORMANCE WEARING COURSE		1,146	16,752	17,898	16,593	1,305	0
2	STP	P171033	ROCK SPRINGS TO UTAH US 191	539.50	545.50	6.00	PAVEMENT REHABILITATION TO INCLUDE MILL, LEVEL AND OVERLAY	2024	176	2,216	2,392	2,155	237	0
<b>FY TOTAL:</b>						<b>19.07</b>			<b>\$1,443</b>	<b>\$24,614</b>	<b>\$26,057</b>	<b>\$23,967</b>	<b>\$2,090</b>	<b>\$0</b>

#### Aeronautics Projects

Fiscal Year: 2029

Aero Comm Dist	Project		General Location	Character of Work	Cost \$1,000							
					PE FY	PE	CE & CON	TOTAL	FED	ST	OTH	
2	AERO	ARK038A	ROCK SPRINGS	PAVEMENT MAINTENANCE		0	1,111	1,111	0	1,000	111	
2	AERO	ARK041A	ROCK SPRINGS	PAVEMENT RECONSTRUCTION		0	3,200	3,200	3,000	120	80	
<b>FY TOTAL:</b>							<b>\$0</b>	<b>\$4,311</b>	<b>\$4,311</b>	<b>\$3,000</b>	<b>\$1,120</b>	<b>\$191</b>
<b>Grand Total: 2029, Sweetwater County</b>							<b>\$1,443</b>	<b>\$28,925</b>	<b>\$30,368</b>	<b>\$26,967</b>	<b>\$3,210</b>	<b>\$191</b>



Wyoming Department of Transportation  
5300 Bishop Blvd  
Cheyenne, WY 82009

## STATE TRANSPORTATION IMPROVEMENT PROJECTS ENGINEERING & CONSTRUCTION

WYCN002B

### Sweetwater County

#### Transportation Projects

Fiscal Year: 2030

Trans Comm Dist	Project		General Location Detail Location	Begin RM	End RM	Length	Character of Work	Cost \$1,000						
								PE FY	PE	CE & CON	TOTAL	FED	ST	OTH
2	STP	1900042	GREEN RIVER SQUAW HOLLOW/WY 530	26.23	33.00	6.77	PAVEMENT REHABILITATION TO INCLUDE MILL, OVERLAY AND CHIP SEAL	2023	129	7,036	7,165	6,475	690	0
2	HI-BFP	B283004	TRANSPORTATION DISTRICT 3 STRUCTURE NO. ARQ, ARR, ARS, ART	150.81	150.81	0.00	BRIDGE REPLACEMENT	2023	664	10,326	10,990	9,945	1,045	0
2	STP-BR	B303013	TRANSPORTATION DISTRICT 3 STRUCTURE NO. JBB, JQL	95.17	95.17	0.00	STRUCTURE REPAIR		45	870	915	828	87	0
2	STP-BR	B303014	TRANSPORTATION DISTRICT 3 STRUCTURE NO. BRK	39.82	39.82	0.00	STRUCTURE REPAIR		7	125	132	119	13	0
2	STP-BR	B303015	TRANSPORTATION DISTRICT 3 STRUCTURE NO. CVW, CVX, DEU	15.50	15.50	0.00	STRUCTURE REPAIR		115	2,210	2,325	2,104	221	0
2	NHPPI-SF	1803154	CRESTON JUNCTION TO RAWLINS I-80 EASTBOUND LANE	187.20	204.10	16.90	FENCING TO INCLUDE SNOW FENCE	2020	405	4,450	4,855	4,503	351	0
2	NHPPI	1803159	WAMSUTTER TO CRESTON JUNCTION I-80 WESTBOUND LANE	186.62	199.05	12.43	PAVEMENT REHABILITATION TO INCLUDE MILL, OVERLAY AND WEARING COURSE		859	13,296	14,155	13,130	1,025	0



Wyoming Department of Transportation  
 5300 Bishop Blvd  
 Cheyenne, WY 82009

**STATE TRANSPORTATION IMPROVEMENT PROJECTS  
 ENGINEERING & CONSTRUCTION**

WYCN002B

**Sweetwater County**

**Transportation Projects**

**Fiscal Year: 2030**

Trans Comm Dist	Project		General Location Detail Location	Begin RM	End RM	Length	Character of Work	Cost \$1,000						
								PE FY	PE	CE & CON	TOTAL	FED	ST	OTH
2	NHPPI	1803161	ROCK SPRINGS TO RAWLINS I-80	153.80	162.00	8.20	PAVEMENT REHABILITATION TO INCLUDE MILL, OVERLAY AND WEARING COURSE		1,496	23,153	24,650	22,865	1,785	0
<b>FY TOTAL:</b>				<b>44.30</b>				<b>\$3,720</b>	<b>\$61,466</b>	<b>\$65,187</b>	<b>\$59,969</b>	<b>\$5,217</b>	<b>\$0</b>	
<b>Grand Total: 2030, Sweetwater County</b>								<b>\$3,720</b>	<b>\$61,466</b>	<b>\$65,187</b>	<b>\$59,969</b>	<b>\$5,217</b>	<b>\$0</b>	



Wyoming Department of Transportation  
 5300 Bishop Blvd  
 Cheyenne, WY 82009

## STATE TRANSPORTATION IMPROVEMENT PROJECTS ENGINEERING & CONSTRUCTION

WYCN002B

### Sweetwater County

#### Transportation Projects

Fiscal Year: 2031

Trans Comm Dist	Project		General Location Detail Location	Begin RM	End RM	Length	Character of Work	Cost \$1,000						
								PE FY	PE	CE & CON	TOTAL	FED	ST	OTH
2	HI-BFP	B313007	TRANSPORTATION DISTRICT 3 STRUCTURE NO. ARK, ARL	145.30	145.30	0.00	BRIDGE REPLACEMENT	2026	448	6,050	6,498	5,880	618	0
2	STP-BR	B313008	TRANSPORTATION DISTRICT 3 STRUCTURE NO. APH	89.69	89.69	0.00	STRUCTURE REPAIR		42	805	847	766	81	0
2	NHPPI	I803160	WAMSUTTER TO CRESTON JUNCTION I-80 EASTBOUND LANE	186.62	199.05	12.43	PAVEMENT REHABILITATION TO INCLUDE MILL, OVERLAY AND WEARING COURSE		859	13,961	14,820	13,747	1,073	0
2	NHPPI	I803163	ROCK SPRINGS TO RAWLINS I-80 EASTBOUND/WESTBOUND LANES	174.40	186.60	12.20	PAVEMENT REHABILITATION TO INCLUDE MILL, OVERLAY AND WEARING COURSE		2,540	39,152	41,692	38,664	3,028	0
<b>FY TOTAL:</b>							<b>24.63</b>		<b>\$3,889</b>	<b>\$59,968</b>	<b>\$63,857</b>	<b>\$59,057</b>	<b>\$4,800</b>	<b>\$0</b>
<b>Grand Total: 2031, Sweetwater County</b>									<b>\$3,889</b>	<b>\$59,968</b>	<b>\$63,857</b>	<b>\$59,057</b>	<b>\$4,800</b>	<b>\$0</b>



Wyoming Department of Transportation  
 5300 Bishop Blvd  
 Cheyenne, WY 82009

## STATE TRANSPORTATION IMPROVEMENT PROJECTS ENGINEERING & CONSTRUCTION

WYCN002B

### Sweetwater County

#### Transportation Projects

Fiscal Year: Future Year

Trans Comm Dist	Project		General Location Detail Location	Begin RM	End RM	Length	Character of Work	Cost \$1,000						
								PE FY	PE	CE & CON	TOTAL	FED	ST	OTH
2	STP	1900045	GREEN RIVER TO UTAH WY 530	0.80	2.66	1.86	PAVEMENT REHABILITATION TO INCLUDE FULL DEPTH RECLAMATION, WEARING COURSE AND ADA	2020	135	7,318	7,452	6,744	709	0
2	SCP-TC	P171031	FLAMING GORGE TO UTAH EAST SIDE ROAD/US 191	503.06	514.03	10.97	PAVEMENT REHABILITATION TO INCLUDE FULL DEPTH RECLAMATION AND OVERLAY	2022	94	15,190	15,284	85	15,199	0
2	STP	P171032	ROCK SPRINGS TO UTAH US 191 SOUTH	545.50	551.39	5.89	PAVEMENT REHABILITATION TO INCLUDE FULL DEPTH RECLAMATION, OVERLAY AND SHIP SEAL	2020	120	11,013	11,132	10,074	1,059	0
2	STP	W374012	LITTLE AMERICA WY 374	69.77	83.56	13.79	PAVEMENT REHABILITATION TO INCLUDE FULL DEPTH RECLAMATION, OVERLAY AND CHIP SEAL	2020	830	9,131	9,960	9,013	947	0
<b>FY TOTAL:</b>						<b>32.51</b>			<b>\$1,179</b>	<b>\$42,652</b>	<b>\$43,828</b>	<b>\$25,916</b>	<b>\$17,914</b>	<b>\$0</b>
<b>Grand Total: Future Year, Sweetwater County</b>									<b>\$1,179</b>	<b>\$42,652</b>	<b>\$43,828</b>	<b>\$25,916</b>	<b>\$17,914</b>	<b>\$0</b>



Wyoming Department of Transportation  
 5300 Bishop Blvd  
 Cheyenne, WY 82009

**STATE TRANSPORTATION IMPROVEMENT PROJECTS  
 COUNTY TOTAL**

WYCN00102SUM

County		Transportation Projects	Transit Projects	Aeronautics Projects	Total
Sweetwater	2026	\$3,517,000	\$865,000	\$6,840,000	\$11,222,000
	2027	\$42,792,000	\$0	\$3,200,000	\$45,992,000
	2028	\$10,086,000	\$0	\$0	\$10,086,000
	2029	\$26,057,000	\$0	\$4,311,000	\$30,368,000
	2030	\$65,187,000	\$0	\$0	\$65,187,000
	2031	\$63,857,000	\$0	\$0	\$63,857,000
	Future Year	\$43,828,000	\$0	\$0	\$43,828,000
	<b>Total</b>	<b>\$255,324,000</b>	<b>\$865,000</b>	<b>\$14,351,000</b>	<b>\$270,540,000</b>